

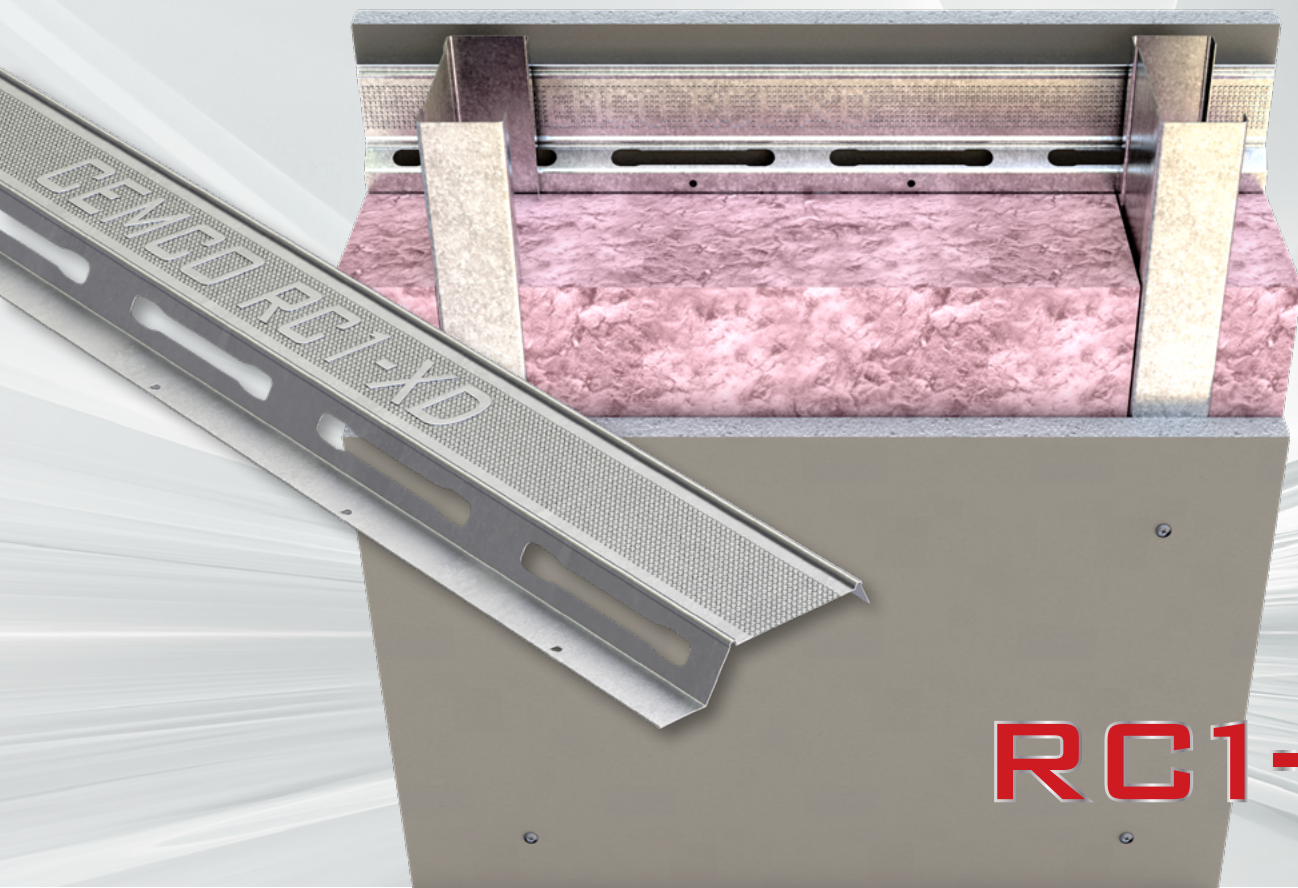

Expanding Your Solutions



RC1-  **XTRA-DUTY**

CEMCO's Premium Resilient Channel for
High-Performance Sound Control

Table of Contents

Introduction	3
--------------------	---

Steel Framed Interior Walls

ViperStud® Interior Framing	4
-----------------------------------	---

STC 50 – TL21-134, STC 51 – M0012.01, STC 51 – M0016.01, STC 54 – TL21-132,
STC 57 – M0013.01, STC 57 – TL21-133, STC 57 – TL21-143, STC 62 – M0014.01

Viper-X® Interior Walls	5
-------------------------------	---

STC 51 – TL21-144, STC 52 – TL21-147, STC 56 – TL21-148, STC 57 – TL21-145,
STC 58 – TL21-149, STC 59 – TL21-146

Wood Framed Interior Walls

2" X 4"	6
---------------	---

STC 51 – TL21-226, STC 56 – TL21-227, STC 59 – TL21-228

2" X 6"	6
---------------	---

STC 51 – TL21-229, STC 58 – TL21-230, STC 62 – TL21-231

Wood Framed Floor/Ceiling

2" x 10"	7–14
----------------	------

Test Assembly - FC21-0015, Test Assembly - FC21-0016,
Test Assembly - FC21-0017, Test Assembly - FC21-0018,
Test Assembly - FC21-0019, Test Assembly - FC21-0020,
Test Assembly - FC21-0021, Test Assembly - FC21-0022

18" Wood Open Web Floor Truss (OWT)	15–19
---	-------

Test Assembly - FC21-00302, Test Assembly - FC21-0303,
Test Assembly - FC21-0304, Test Assembly - FC21-0305,
Test Assembly - FC21-0306

Introduction

CEMCO® RC1-XD™

CEMCO's new "XTRA-DUTY" solution for high-end sound abatement systems RC1-XD STC Ratings meet or exceed other high-end sound abatement channels. Made from the same high quality hot-dipped galvanized steel as other CEMCO products, RC1-XD is:

- Sound tested in accordance with ASTM E90.
- Available in standard G40. G60 is available upon special request.
- Tested in both ViperStud® and Viper-X® non-load bearing wall assemblies.
- Perfect for both commercial and residential applications.
- All RC1-XD sound test reports available at www.cemcosteel.com in the Sound Test Reports Section.
- For more information contact your local CEMCO sales representative.
- For technical support contact CEMCO's Technical Services Department at 800-416-2278.

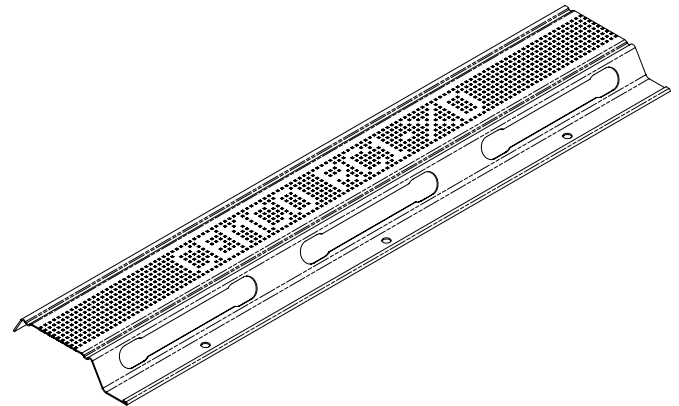
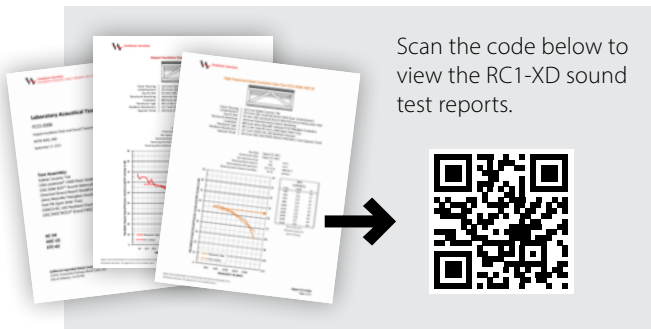

LEED v4 for Building & Design Construction

- MR Prerequisite: Construction and Demolition Waste Management Planning.
- MR Credit: Construction and Demolition Waste Management.
- MR Credit: Building Product Disclosure and Optimization – Sourcing of Raw Materials, Option 2.
- MR Credit: Building Product Disclosure and Optimization – Material Ingredients, Option 1.
- MR Credit: Building Life-Cycle Impact Reduction, Option 4.

Recycled Content (Steel Products Only)

- Total Recycled Content: 36.9%
- Post-Consumer: 19.8%
- Pre-Consumer: 14.4%

California's Proposition 65 Warning

California's Safe Drinking Water and Toxic Enforcement Act of 1986 – commonly referred to as Proposition 65 ("Prop 65") (27 Cal. Code Reg. § 25600, et seq.) – has recently changed, requiring manufacturers to provide a warning based on its knowledge about the presence of one or more of the almost 900 listed chemicals which are known to the State of California to cause cancer and birth defects, or other reproductive harm. With a few exceptions, manufacturers operating in the state of California as well as those entities who distribute, import, package, and/or supply products into the State of California are now required provide a "clear and reasonable" warning to consumers that their products may contain one or more of these listed chemicals or compounds. The complete list is available at www.P65Warnings.ca.gov.

In compliance with the new requirements, we are notifying each of our customers that CEMCO products contain Nickel (metallic) and/or other chemicals listed which are known to the State of California to cause cancer and birth defects or other reproductive harm. Safety data sheets from our major suppliers are available from CEMCO on our web-site at www.cemcosteel.com.

Steel Thickness

Color Code (painted on ends)	Mil Thickness	Design Thickness (in.) ¹	Minimum Thickness (in.) ^{1,2}
None	22	0.023 (0.59 mm)	0.022 (0.56 mm)

1) Uncoated Steel Thickness. Thickness is for carbon sheet steel.

2) Minimum Thickness represents 95% of the design thickness and is the minimum acceptable thickness delivered to the job site, based on the AISI.

ASTM & Code Standards

- ASTM A653/A653M, A924/A924M, C645, A1003/A1003M, C754 (installation)
- IBC: 2012, 2015, 2018
- CBC: 2013, 2016, 2019
- AISI: S100-07, S100-12, S100-16, S220-11, S220-15

RC1-XD™



CEMCO's RC1-XD (Xtra-Duty) Resilient Channel is manufactured from 22 mil thick G40 steel with a large 1-1/2" top screw flange, 1/2" bottom flange for nailing/screwing into wood/steel studs providing a full 1/2" furring height. G60 available upon special request.

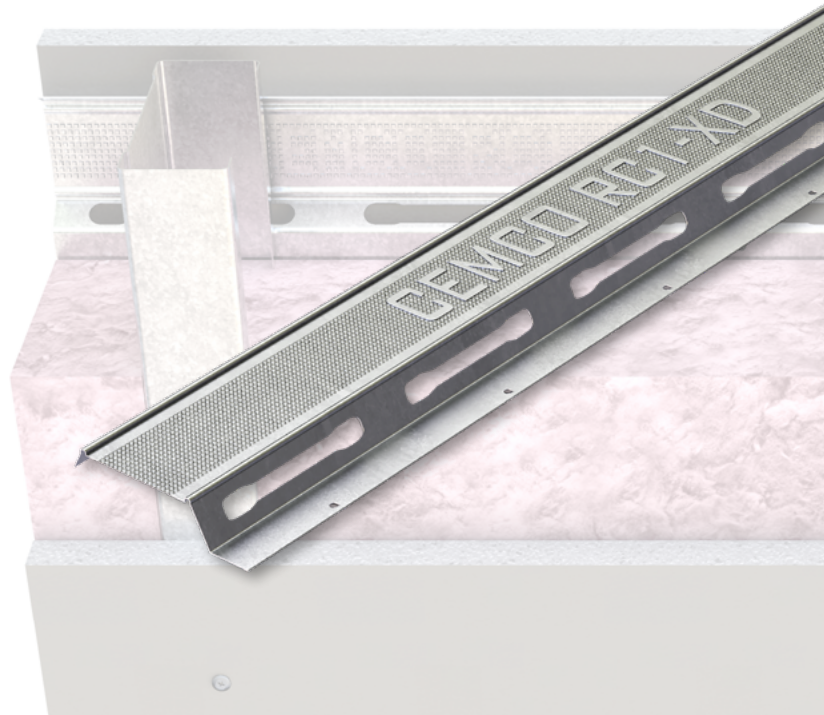
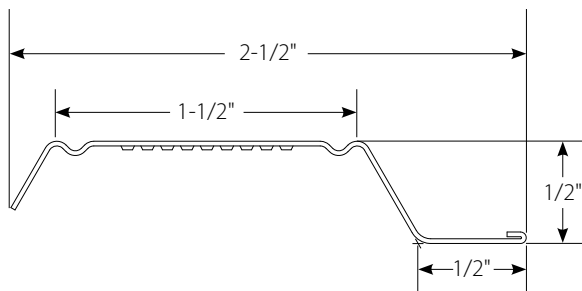

RC1-XD Sound Assemblies

Partition Type	Assembly Description	Stud Spacing	STC Rating / Test Report	
			362VS125-18 STC (Test Report)	362VS125-33 STC (Test Report)
	<ul style="list-style-type: none"> 3-5/8" ViperStud® 3-1/2" R-13 unfaced insulation RC1-XD™ w/ 1 layer 5/8" Type X GWB on one side 1 layer 5/8" Type X GWB on the other side 	24" o.c.	51 (M0012.01)	50 (TL21-134)
		16" o.c.	51 (M0016.01)	N/A
	<ul style="list-style-type: none"> 3-5/8" ViperStud® 3-1/2" R-13 unfaced insulation RC1-XD™ w/ 2 layers 5/8" Type X GWB on one side 1 layer 5/8" Type X GWB on the other side 	24" o.c.	57 (M0013.01)	54 (TL21-132)
		16" o.c.	55 (TL21-142)	N/A
	<ul style="list-style-type: none"> 3-5/8" ViperStud® 3-1/2" R-13 unfaced insulation RC1-XD™ w/ 2 layers 5/8" Type X GWB on one side 2 layers 5/8" Type X GWB on the other side 	24" o.c.	62 (M0014.01)	57 (TL21-133)
		16" o.c.	57 (TL21-143)	N/A

Notes:





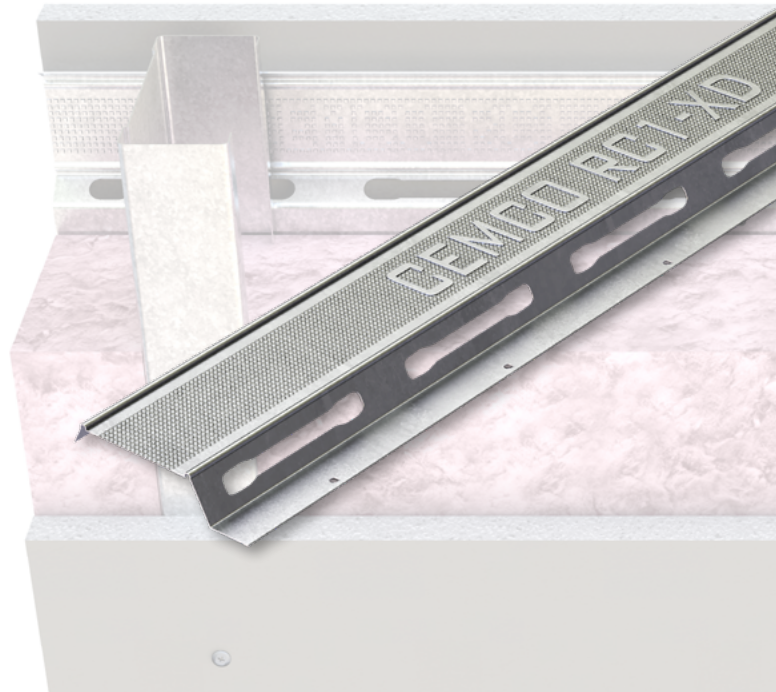
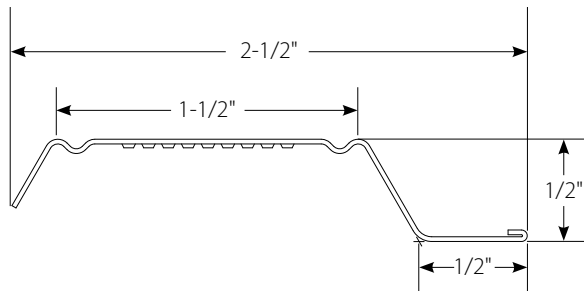

1. RC1-XD must be installed per the respective sound test report.
2. All sound test reports performed in accordance with ASTM E90 are available at www.cemcosteel.com.
3. Contact CEMCO Technical Services at 800-416-1178 for additional assistance.
4. Sound Transmission Class (STC) determined in accordance with ASTM E413-10.

RC1-

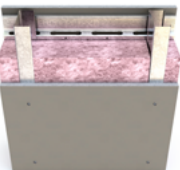
CEMCO's RC1-XD (Xtra-Duty) Resilient Channel is manufactured from 22 mil thick G40 steel with a large 1-1/2" top screw flange, 1/2" bottom flange for nailing/screwing into wood/steel studs providing a full 1/2" furring height. G60 available upon special request.

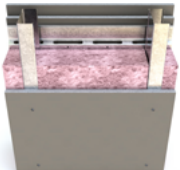

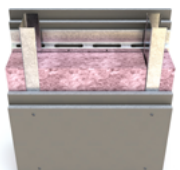
RC1-XD Sound Assemblies

Partition Type	Assembly Description	Stud Spacing	STC Rating / Test Report	
			362VXS144-18 STC (Test Report)	
	<ul style="list-style-type: none"> 3-5/8" Viper-X® Stud 3-1/2" R-13 unfaced insulation RC1-XD™ w/ 1 layer 5/8" Type X GWB on one side 1 layer 5/8" Type X GWB on the other side 	24" o.c.	52 (TL21-147)	
		16" o.c.	51 (TL21-144)	
	<ul style="list-style-type: none"> 3-5/8" Viper-X® Stud 3-1/2" R-13 unfaced insulation RC1-XD™ w/ 2 layers 5/8" Type X GWB on one side 1 layer 5/8" Type X GWB on the other side 	24" o.c.	56 (TL21-148)	
		16" o.c.	57 (TL21-145)	
	<ul style="list-style-type: none"> 3-5/8" Viper-X® Stud 3-1/2" R-13 unfaced insulation RC1-XD™ w/ 2 layers 5/8" Type X GWB on one side 2 layers 5/8" Type X GWB on the other side 	24" o.c.	58 (TL21-149)	
		16" o.c.	59 (TL21-146)	

Notes:

1. RC1-XD must be installed per the respective sound test report.
2. All sound test reports performed in accordance with ASTM E90 are available at www.cemcosteel.com.
3. Contact CEMCO Technical Services at 800-416-1178 for additional assistance.
4. Sound Transmission Class (STC) determined in accordance with ASTM E413-10.

RC1-

CEMCO's RC1-XD (Xtra-Duty) Resilient Channel is manufactured from 22 mil thick G40 steel with a large 1-1/2" top screw flange, 1/2" bottom flange for nailing/screwing into wood/steel studs providing a full 1/2" furring height. G60 available upon special request.

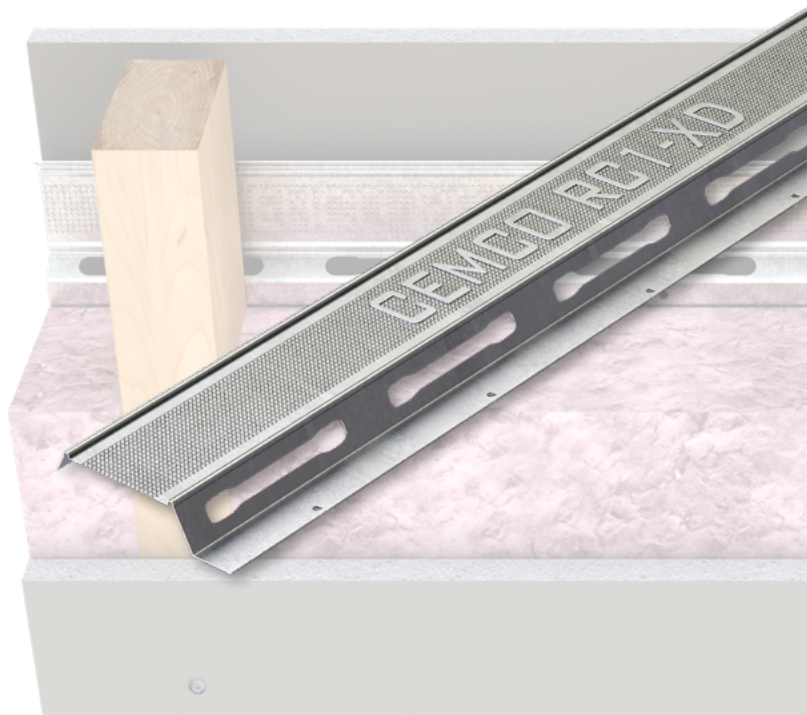
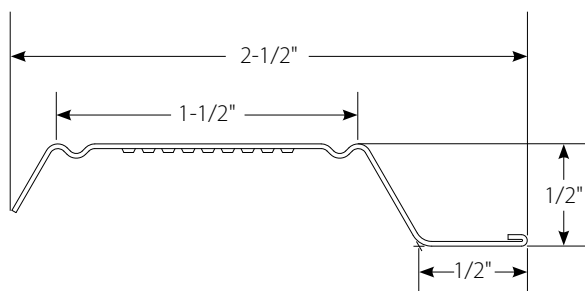

RC1-XD Sound Assemblies

Partition Type	Assembly Description	Stud Spacing	STC Rating / Test Report	
			2 x 4 Wood Studs STC (Test Report)	2 x 6 Wood Studs STC (Test Report)
	<ul style="list-style-type: none"> Nominal "2 x" Wood Wall Stud R-13 unfaced insulation (2 x 4) R-19 unfaced insulation (2 x 6) RC1-XD™ w/1 layer 5/8" Type X GXB one side 1 layer 5/8" Type X on the other side 	16" o.c.	51 (TL21-226)	51 (TL21-229)
	<ul style="list-style-type: none"> Nominal "2 x" Wood Wall Stud R-13 unfaced insulation (2 x 4) R-19 unfaced insulation (2 x 6) RC1-XD w/2 layers 5/8" Type X GXB one side 1 layer 5/8" Type X on the other side 	16" o.c.	56 (TL21-227)	58 (TL21-230)
	<ul style="list-style-type: none"> Nominal "2 x" Wood Wall Stud R-13 unfaced insulation (2 x 4) R-19 unfaced insulation (2 x 6) RC1-XD w/2 layers 5/8" Type X GXB one side 2 layers 5/8" Type X on the other side 	16" o.c.	59 (TL21-228)	62 (TL21-231)

Notes:

1. RC1-XD must be installed per the respective sound test report.
2. All sound test reports performed in accordance with ASTM E90 are available at www.cemcosteel.com.
3. Contact CEMCO Technical Services at 800-416-1178 for additional assistance.
4. Sound Transmission Class (STC) determined in accordance with ASTM E413-10.

RC1-

CEMCO's RC1-XD (Xtra-Duty) Resilient Channel is manufactured from 22 mil thick G40 steel with a large 1-1/2" top screw flange, 1/2" bottom flange for nailing/screwing into wood/steel studs providing a full 1/2" furring height. G60 available upon special request.

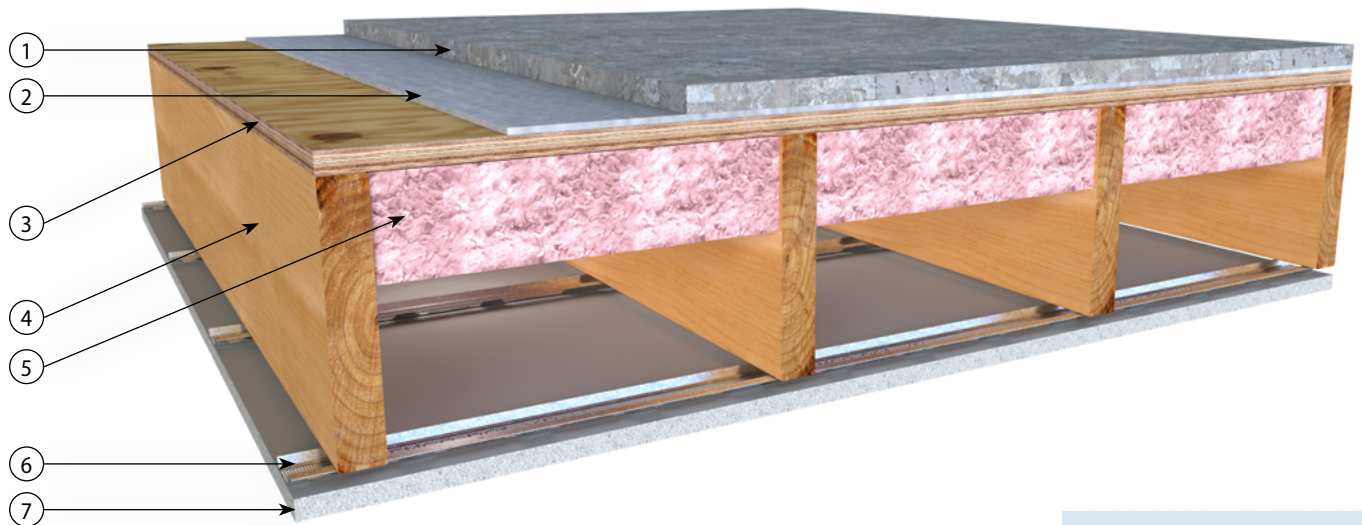
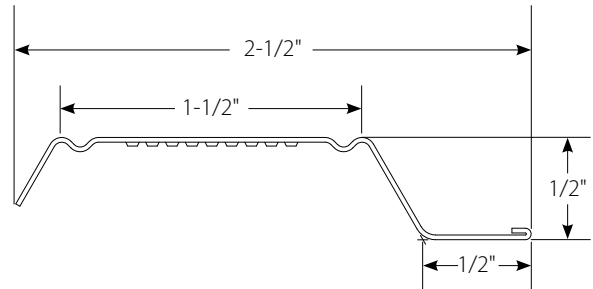

Click here to view
the FC21-0015
Sound Test Report.

RC1-XD Floor/Ceiling Sound Assemblies – FC21-0015

Item	Assembly Description	FC21-0015	IIC	HIIC	STC
--	Finish Floor	n/a	55	53	60
--	Noise Suppression/Underlayment	n/a			
1	Gypsum Topping	MAXXON Gyp-Crete® Gypsum Concrete (25 mm)			
2	Sound Mat	MAXXON Acousti-Mat 1/4 (6 mm)			
3	Structural Sheathing	3/4" Plywood (19 mm)			
4	Structural Type	2" x 10" Dimensional Lumber (235 mm)			
5	Insulation	CertainTeed R-13 Fiberglass Insulation (89 mm)			
6	Resilient Attachment	1/2" CEMCO RC1-XD™ (13 mm)			
7	Finish Ceiling Layer 1	3/4" PABCO® Sound Curb™ Type X Gypsum Board (19 mm)			

Notes:

1. RC1-XD must be installed per the respective sound test report.
2. All sound test reports performed in accordance with ASTM E90 are available at www.cemcosteel.com.
3. Contact CEMCO Technical Services at 800-416-1178 for additional assistance.
4. Sound Transmission Class (STC) determined in accordance with ASTM E413-10.



RC1-™

XTRA-DUTY

CEMCO's RC1-XD (Xtra-Duty) Resilient Channel is manufactured from 22 mil thick G40 steel with a large 1-1/2" top screw flange, 1/2" bottom flange for nailing/screwing into wood/steel studs providing a full 1/2" furring height. G60 available upon special request.

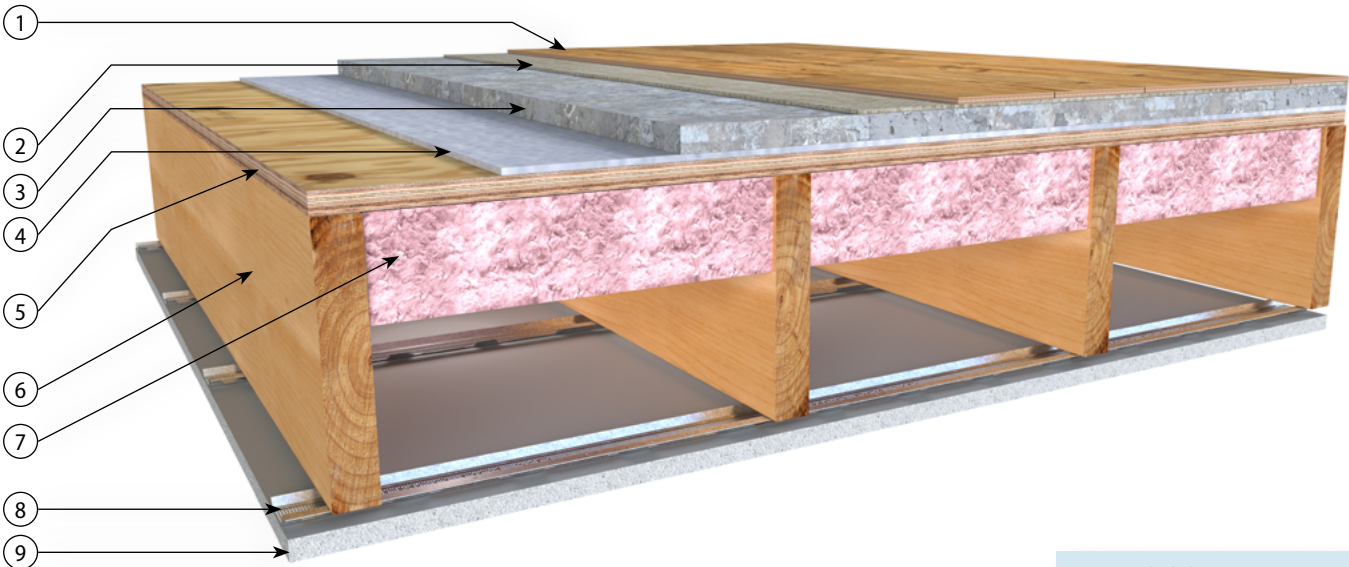
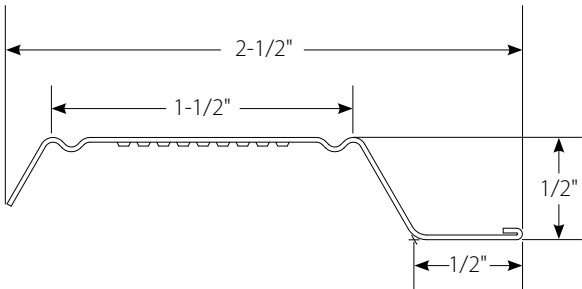

 [Click here to view the FC21-0016 Sound Test Report.](#)

RC1-XD Floor/Ceiling Sound Assemblies – FC21-0016

Item	Assembly Description	FC21-0016	IIC	HIIC	STC
1	Finish Floor	Paradigm Luxury Vinyl Plank (7 mm)	61	74	60
2	Noise Suppression/Underlayment	Silent Walk Noise Suppression System (4 mm)			
3	Gypsum Topping	MAXXON Gyp-Crete® Gypsum Concrete (25 mm)			
4	Sound Mat	MAXXON Acousti-Mat 1/4 (6 mm)			
5	Structural Sheathing	3/4" Plywood (19 mm)			
6	Structural Type	2" x 10" Dimensional Lumber (235 mm)			
7	Insulation	CertainTeed R-13 Fiberglass Insulation (89 mm)			
8	Resilient Attachment	1/2" CEMCO RC1-XD™ (13 mm)			
9	Finish Ceiling Layer 1	3/4" PABCO® Sound Curb™ Type X Gypsum Board (19 mm)			

Notes:
1. RC1-XD must be installed per the respective sound test report.
2. All sound test reports performed in accordance with ASTM E90 are available at www.cemcosteel.com.
3. Contact CEMCO Technical Services at 800-416-1178 for additional assistance.
4. Sound Transmission Class (STC) determined in accordance with ASTM E413-10.

RC1-

CEMCO's RC1-XD (Xtra-Duty) Resilient Channel is manufactured from 22 mil thick G40 steel with a large 1-1/2" top screw flange, 1/2" bottom flange for nailing/screwing into wood/steel studs providing a full 1/2" furring height. G60 available upon special request.

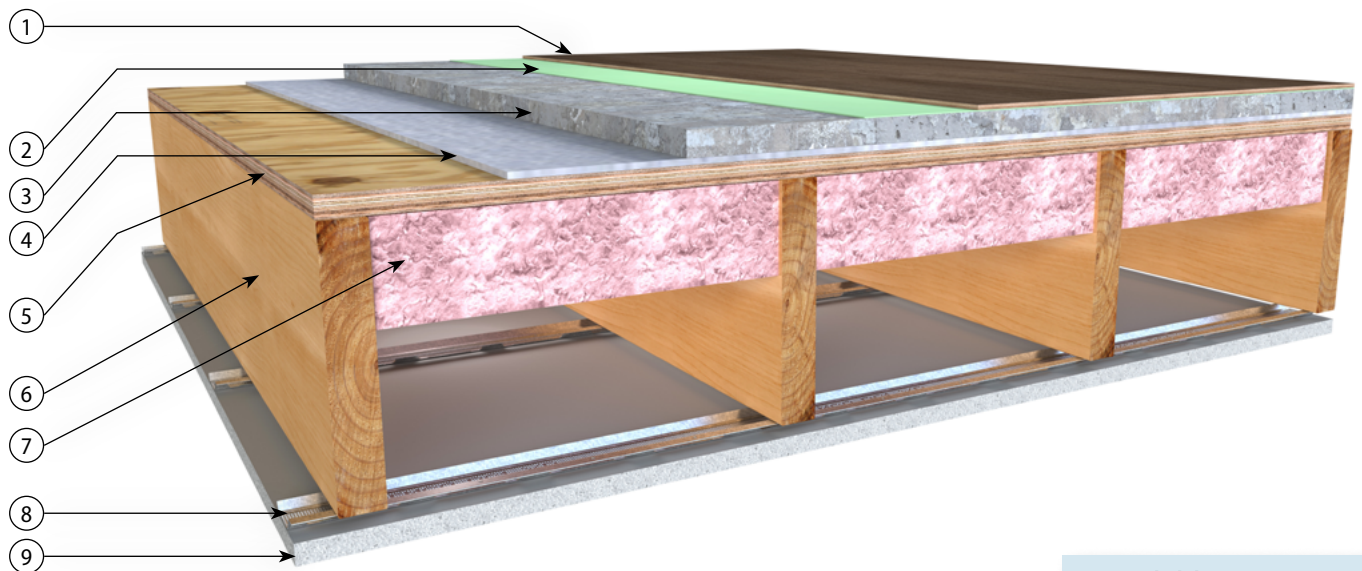
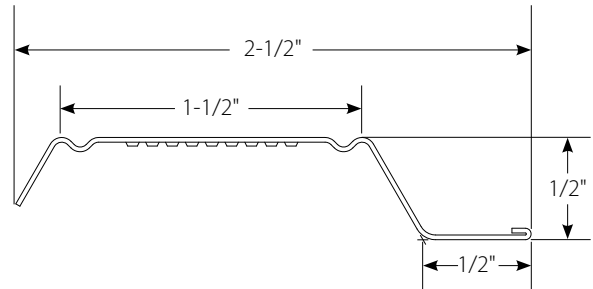

[Click here to view the FC21-0017 Sound Test Report.](#)

RC1-XD Floor/Ceiling Sound Assemblies – FC21-0017

Item	Assembly Description	FC21-0017	IIC	HIIC	STC
1	Finish Floor	4063V/V4063 Xsoundscape with Integrated Pad (5 mm)	61	75	60
2	Noise Suppression/Underlayment	Shaw GroundWorks Acoustical Underlayment (1.4 mm)			
3	Gypsum Topping	MAXXON Gyp-Crete® Gypsum Concrete (25 mm)			
4	Sound Mat	MAXXON Acousti-Mat 1/4 (6 mm)			
5	Structural Sheathing	3/4" Plywood (19 mm)			
6	Structural Type	2" x 10" Dimensional Lumber (235 mm)			
7	Insulation	CertainTeed R-13 Fiberglass Insulation (89 mm)			
8	Resilient Attachment	1/2" CEMCO RC1-XD™ (13 mm)			
9	Finish Ceiling Layer 1	3/4" PABCO® Sound Curb™ Type X Gypsum Board (19 mm)			

Notes:

1. RC1-XD must be installed per the respective sound test report.
2. All sound test reports performed in accordance with ASTM E90 are available at www.cemcosteel.com.
3. Contact CEMCO Technical Services at 800-416-1178 for additional assistance.
4. Sound Transmission Class (STC) determined in accordance with ASTM E413-10.



RC1-™

XTRA-DUTY

CEMCO's RC1-XD (Xtra-Duty) Resilient Channel is manufactured from 22 mil thick G40 steel with a large 1-1/2" top screw flange, 1/2" bottom flange for nailing/screwing into wood/steel studs providing a full 1/2" furring height. G60 available upon special request.

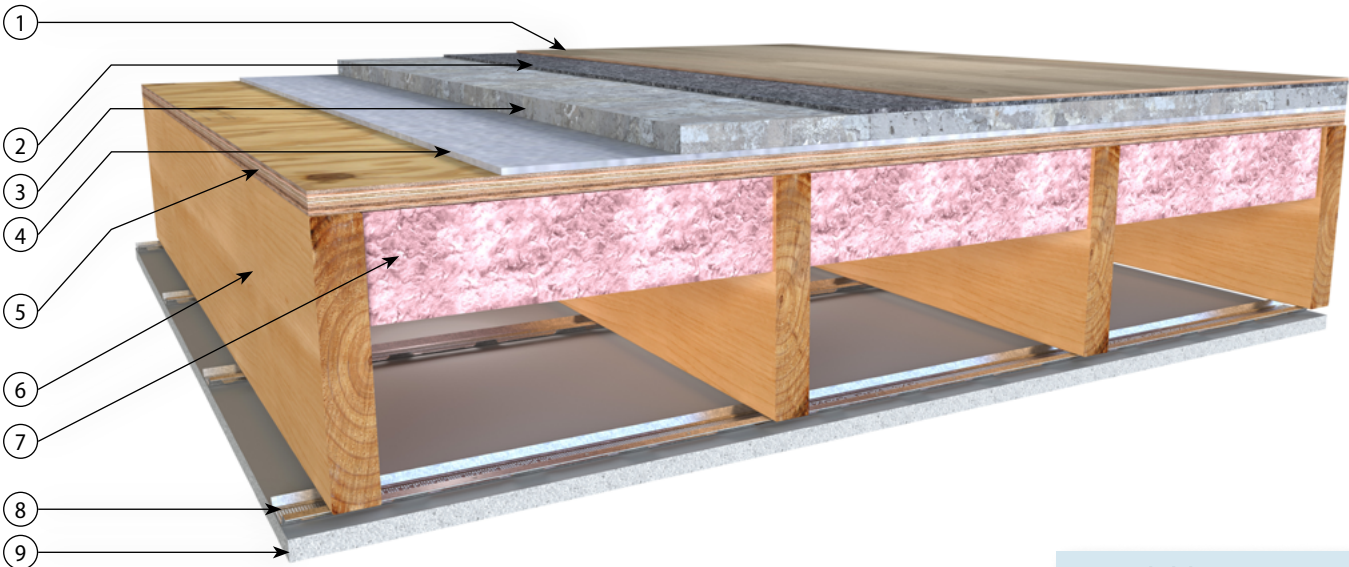
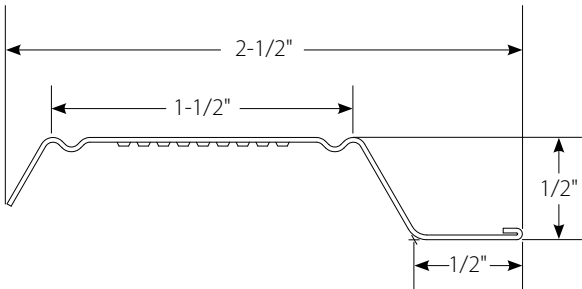

 [Click here to view the FC21-0018 Sound Test Report.](#)

RC1-XD Floor/Ceiling Sound Assemblies – FC21-0018

Item	Assembly Description	FC21-0018	IIC	HIIC	STC
1	Finish Floor	Shaw Local Reserve SPC Flooring (4 mm)	61	81	59
2	Noise Suppression/Underlayment	Shaw 12 oz. green Dilour Underlayment (4 mm)			
3	Gypsum Topping	MAXXON Gyp-Crete® Gypsum Concrete (25 mm)			
4	Sound Mat	MAXXON Acousti-Mat 1/4 (6 mm)			
5	Structural Sheathing	3/4" Plywood (19 mm)			
6	Structural Type	2" x 10" Dimensional Lumber (235 mm)			
7	Insulation	CertainTeed R-13 Fiberglass Insulation (89 mm)			
8	Resilient Attachment	1/2" CEMCO RC1-XD™ (13 mm)			
9	Finish Ceiling Layer 1	3/4" PABCO® Sound Curb™ Type X Gypsum Board (19 mm)			

Notes:
1. RC1-XD must be installed per the respective sound test report.
2. All sound test reports performed in accordance with ASTM E90 are available at www.cemcosteel.com.
3. Contact CEMCO Technical Services at 800-416-1178 for additional assistance.
4. Sound Transmission Class (STC) determined in accordance with ASTM E413-10.

RC1-

CEMCO's RC1-XD (Xtra-Duty) Resilient Channel is manufactured from 22 mil thick G40 steel with a large 1-1/2" top screw flange, 1/2" bottom flange for nailing/screwing into wood/steel studs providing a full 1/2" furring height. G60 available upon special request.

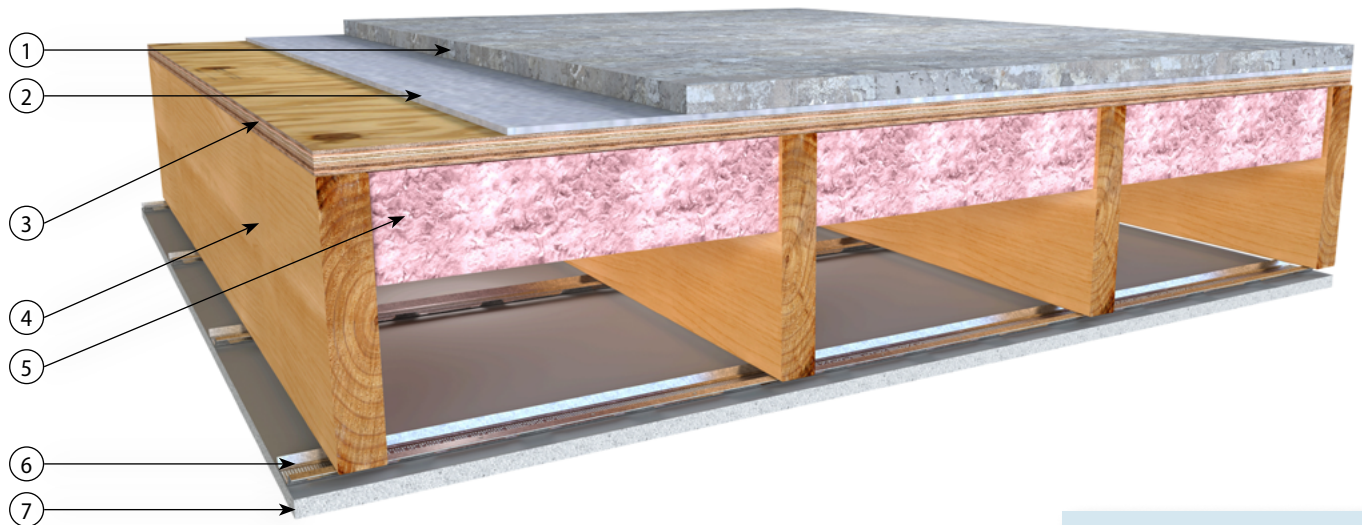
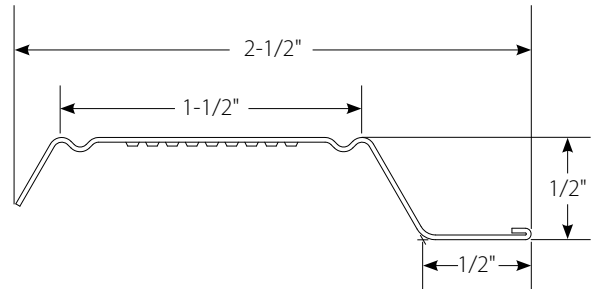

[Click here to view the FC21-0019 Sound Test Report.](#)

RC1-XD Floor/Ceiling Sound Assemblies – FC21-0019

Item	Assembly Description	FC21-0019	IIC	HIIC	STC
--	Finish Floor	n/a	52	51	59
--	Noise Suppression/Underlayment	n/a			
1	Gypsum Topping	MAXXON Gyp-Crete® Gypsum Concrete (25 mm)			
2	Sound Mat	MAXXON Acousti-Mat 1/4 (6 mm)			
3	Structural Sheathing	3/4" Plywood (19 mm)			
4	Structural Type	2" x 10" Dimensional Lumber (235 mm)			
5	Insulation	CertainTeed R-13 Fiberglass Insulation (89 mm)			
6	Resilient Attachment	1/2" CEMCO RC1-XD™ (13 mm)	52	51	59
7	Finish Ceiling Layer 1	5/8" USG SHEETROCK Brand FIRECODE C Core Gypsum Panel (16 mm)			

Notes:

1. RC1-XD must be installed per the respective sound test report.
2. All sound test reports performed in accordance with ASTM E90 are available at www.cemcosteel.com.
3. Contact CEMCO Technical Services at 800-416-1178 for additional assistance.
4. Sound Transmission Class (STC) determined in accordance with ASTM E413-10.



RC1-™

XTRA-DUTY

CEMCO's RC1-XD (Xtra-Duty) Resilient Channel is manufactured from 22 mil thick G40 steel with a large 1-1/2" top screw flange, 1/2" bottom flange for nailing/screwing into wood/steel studs providing a full 1/2" furring height. G60 available upon special request.

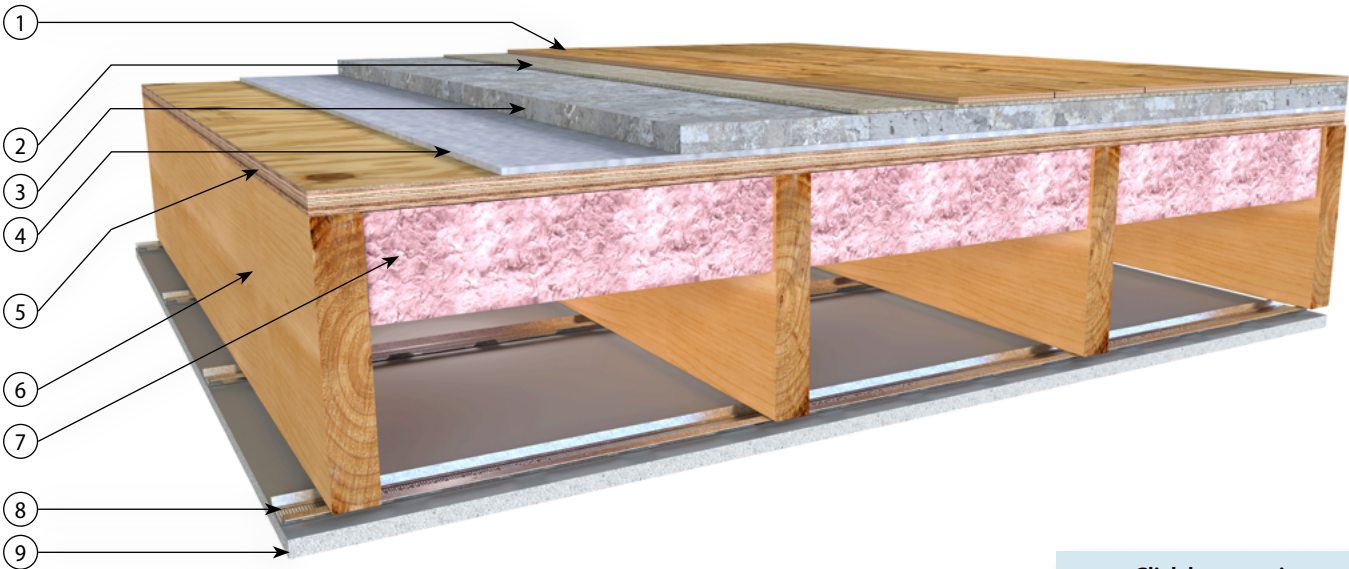
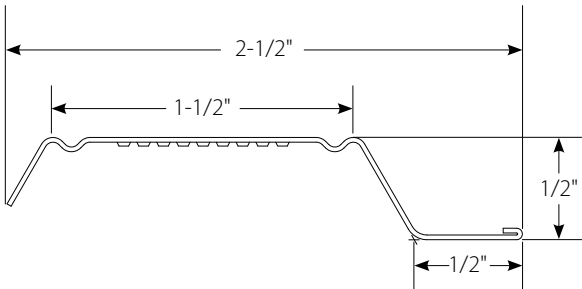

 [Click here to view the FC21-0020 Sound Test Report.](#)

RC1-XD Floor/Ceiling Sound Assemblies – FC21-0020

Item	Assembly Description	FC21-0020	IIC	HIIC	STC
1	Finish Floor	Paradigm Luxury Vinyl Plank (7 mm)	58	71	59
2	Noise Suppression/Underlayment	Silent Walk Noise Suppression System (4 mm)			
3	Gypsum Topping	MAXXON Gyp-Crete® Gypsum Concrete (25 mm)			
4	Sound Mat	MAXXON Acousti-Mat 1/4 (6 mm)			
5	Structural Sheathing	3/4" Plywood (19 mm)			
6	Structural Type	2" x 10" Dimensional Lumber (235 mm)			
7	Insulation	CertainTeed R-13 Fiberglass Insulation (89 mm)			
8	Resilient Attachment	1/2" CEMCO RC1-XD™ (13 mm)			
9	Finish Ceiling Layer 1	5/8" USG SHEETROCK Brand FIRECODE C Core Gypsum Panel (16 mm)			

Notes:
1. RC1-XD must be installed per the respective sound test report.
2. All sound test reports performed in accordance with ASTM E90 are available at www.cemcosteel.com.
3. Contact CEMCO Technical Services at 800-416-1178 for additional assistance.
4. Sound Transmission Class (STC) determined in accordance with ASTM E413-10.

RC1-

CEMCO's RC1-XD (Xtra-Duty) Resilient Channel is manufactured from 22 mil thick G40 steel with a large 1-1/2" top screw flange, 1/2" bottom flange for nailing/screwing into wood/steel studs providing a full 1/2" furring height. G60 available upon special request.

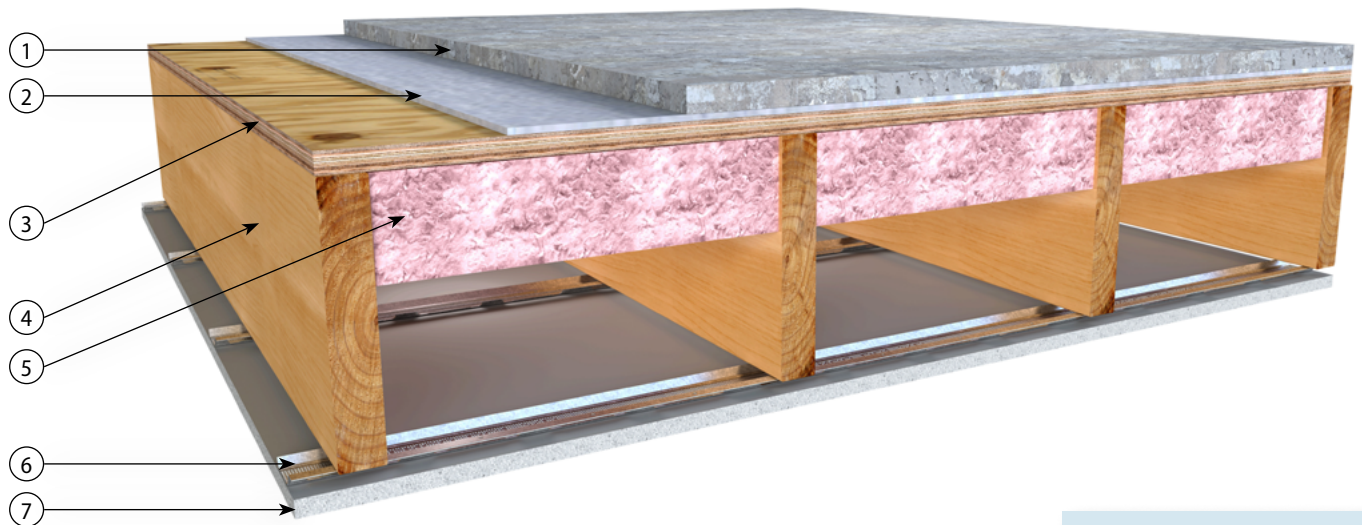
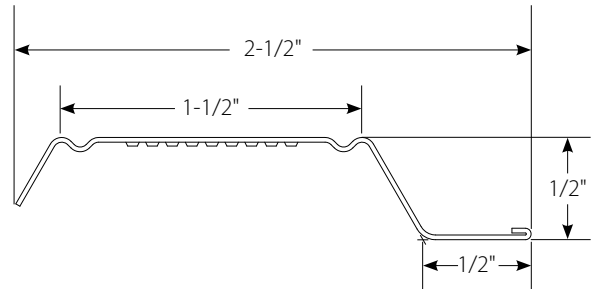

[Click here to view the FC21-0021 Sound Test Report.](#)

RC1-XD Floor/Ceiling Sound Assemblies – FC21-0021

Item	Assembly Description	FC21-0021	IIC	HIIC	STC
--	Finish Floor	n/a	54	53	60
--	Noise Suppression/Underlayment	n/a			
1	Gypsum Topping	MAXXON Gyp-Crete® Gypsum Concrete (25 mm)			
2	Sound Mat	MAXXON Acousti-Mat 1/4 (6 mm)			
3	Structural Sheathing	3/4" Plywood (19 mm)			
4	Structural Type	2" x 10" Dimensional Lumber (235 mm)			
5	Insulation	CertainTeed R-13 Fiberglass Insulation (89 mm)			
6	Resilient Attachment	1/2" CEMCO RC1-XD™ (13 mm)			
7	Finish Ceiling Layer 1	5/8" National Gypsum Gold Bond Fire-Shield Type X Panel (16 mm)			

- Notes:**
1. RC1-XD must be installed per the respective sound test report.
 2. All sound test reports performed in accordance with ASTM E90 are available at www.cemcosteel.com.
 3. Contact CEMCO Technical Services at 800-416-1178 for additional assistance.
 4. Sound Transmission Class (STC) determined in accordance with ASTM E413-10.



RC1-™

XTRA-DUTY

CEMCO's RC1-XD (Xtra-Duty) Resilient Channel is manufactured from 22 mil thick G40 steel with a large 1-1/2" top screw flange, 1/2" bottom flange for nailing/screwing into wood/steel studs providing a full 1/2" furring height. G60 available upon special request.

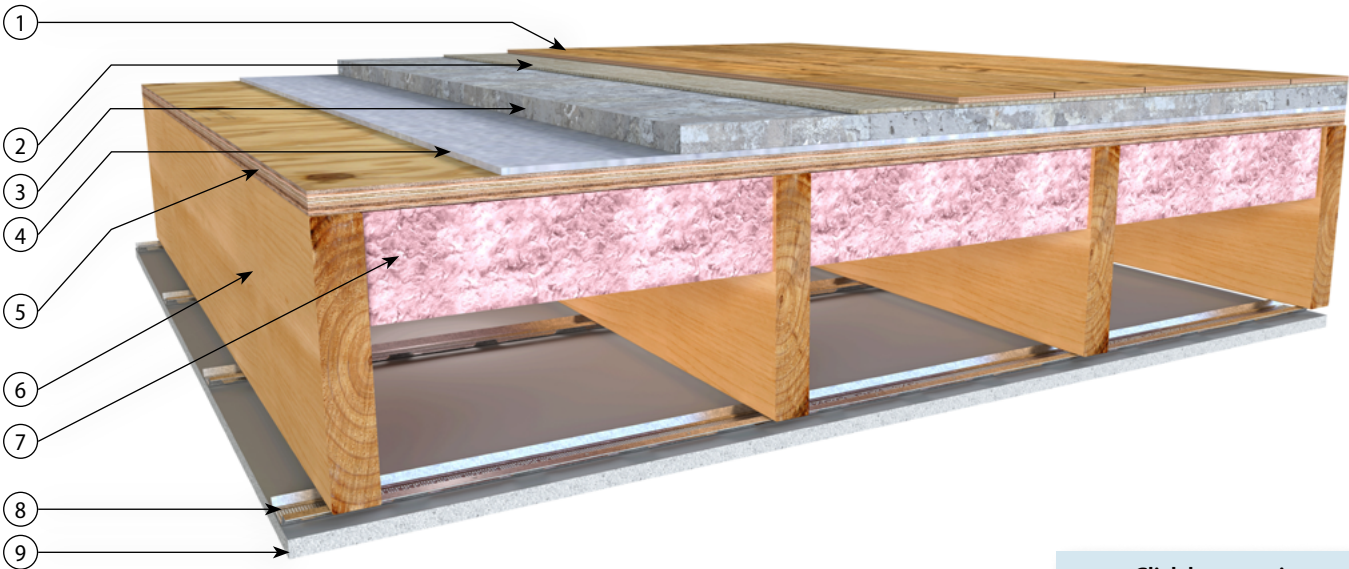
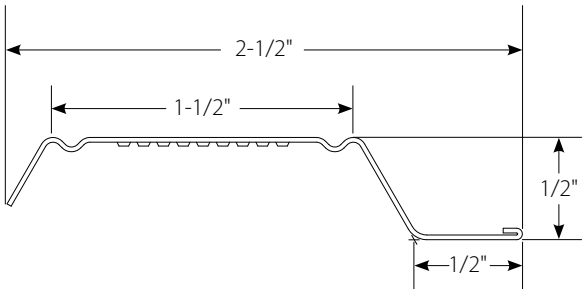

 [Click here to view the FC21-0022 Sound Test Report.](#)

RC1-XD Floor/Ceiling Sound Assemblies – FC21-0022

Item	Assembly Description	FC21-0022	IIC	HIIC	STC
1	Finish Floor	Paradigm Luxury Vinyl Plank (7 mm)	58	72	59
2	Noise Suppression/Underlayment	Silent Walk Noise Suppression System (4 mm)			
3	Gypsum Topping	MAXXON Gyp-Crete® Gypsum Concrete (25 mm)			
4	Sound Mat	MAXXON Acousti-Mat 1/4 (6 mm)			
5	Structural Sheathing	3/4" Plywood (19 mm)			
6	Structural Type	2" x 10" Dimensional Lumber (235 mm)			
7	Insulation	CertainTeed R-13 Fiberglass Insulation (89 mm)			
8	Resilient Attachment	1/2" CEMCO RC1-XD™ (13 mm)			
9	Finish Ceiling Layer 1	5/8" National Gypsum Gold Bond Fire-Shield Type X Panel (16 mm)			

- Notes:**
- 1. RC1-XD must be installed per the respective sound test report.
 - 2. All sound test reports performed in accordance with ASTM E90 are available at www.cemcosteel.com.
 - 3. Contact CEMCO Technical Services at 800-416-1178 for additional assistance.
 - 4. Sound Transmission Class (STC) determined in accordance with ASTM E413-10.

RC1-

CEMCO's RC1-XD (Xtra-Duty) Resilient Channel is manufactured from 22 mil thick G40 steel with a large 1-1/2" top screw flange, 1/2" bottom flange for nailing/screwing into wood/steel studs providing a full 1/2" furring height. G60 available upon special request.

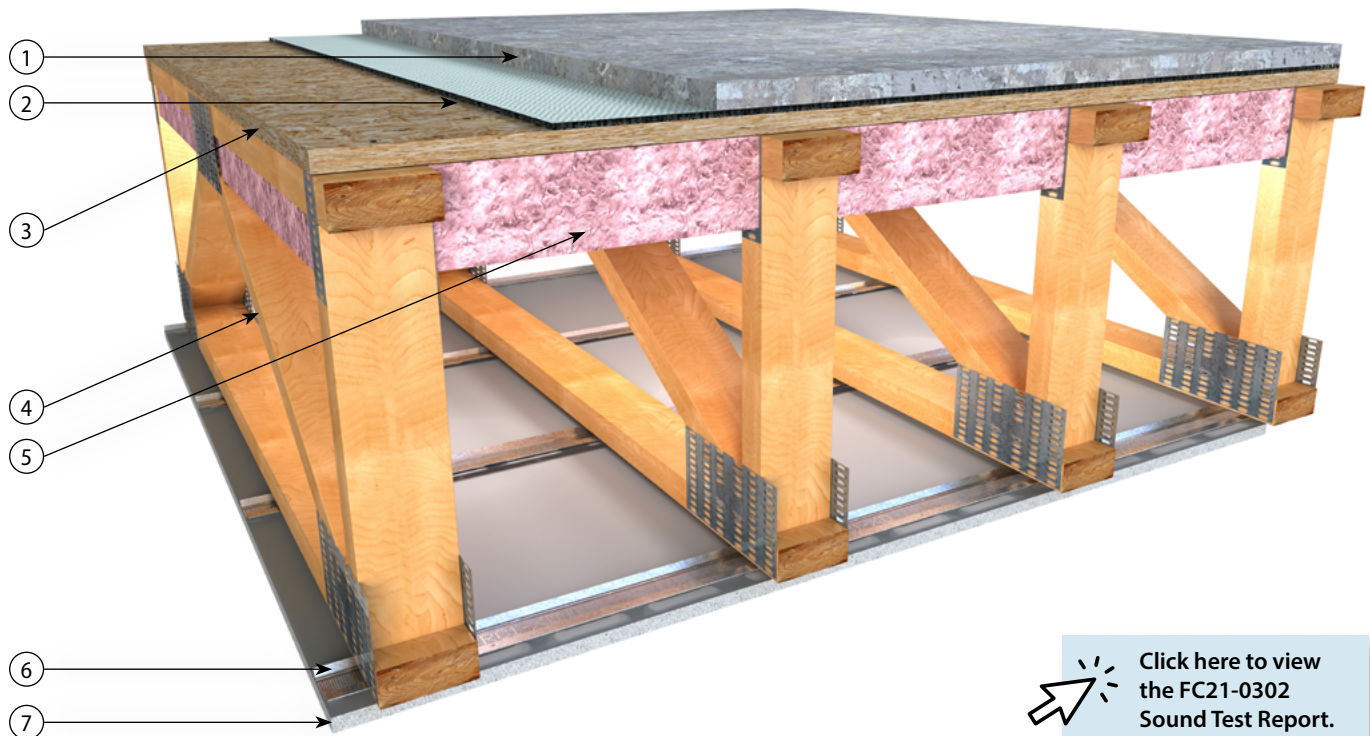
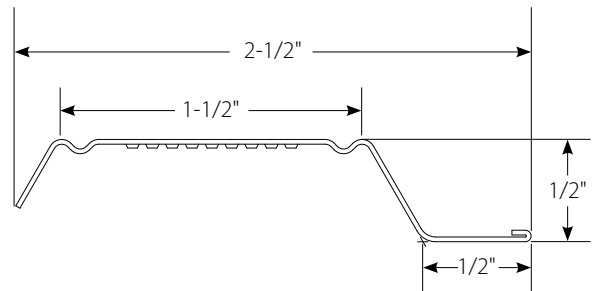

**Click here to view
the FC21-0302
Sound Test Report.**

RC1-XD Floor/Ceiling Sound Assemblies – FC21-0302

Item	Assembly Description	FC21-0302	IIC	HIIC	STC
--	Finish Floor	n/a	50	51	60
--	Noise Suppression/Underlayment	n/a			
1	Gypsum Topping	1" USG LEVELROCK Brand 2500 Floor Underlayment (25.4 mm)			
2	Sound Mat	1/4" USG LEVELROCK Brand SAM-N25 Sound Attenuation Mat (6 mm)			
3	Structural Sheathing	3/4" Plywood (19 mm)			
4	Structural Type	18" York PB Truss L/360 OWT (457 mm)			
5	Insulation	Johns Manville R-13 Fiberglass Insulation (89 mm)			
6	Resilient Attachment	1/2" CEMCO RC1-XD™ (13 mm)			
7	Finish Ceiling Layer 1	5/8" USG SHEETROCK Brand FIRECODE C Core Gypsum Panel (16 mm)			

Notes:

1. RC1-XD must be installed per the respective sound test report.
2. All sound test reports performed in accordance with ASTM E90 are available at www.cemcosteel.com.
3. Contact CEMCO Technical Services at 800-416-1178 for additional assistance.
4. Sound Transmission Class (STC) determined in accordance with ASTM E413-10.

RC1-XD™ XTRA-DUTY

CEMCO's RC1-XD (Xtra-Duty) Resilient Channel is manufactured from 22 mil thick G40 steel with a large 1-1/2" top screw flange, 1/2" bottom flange for nailing/screwing into wood/steel studs providing a full 1/2" furring height. G60 available upon special request.

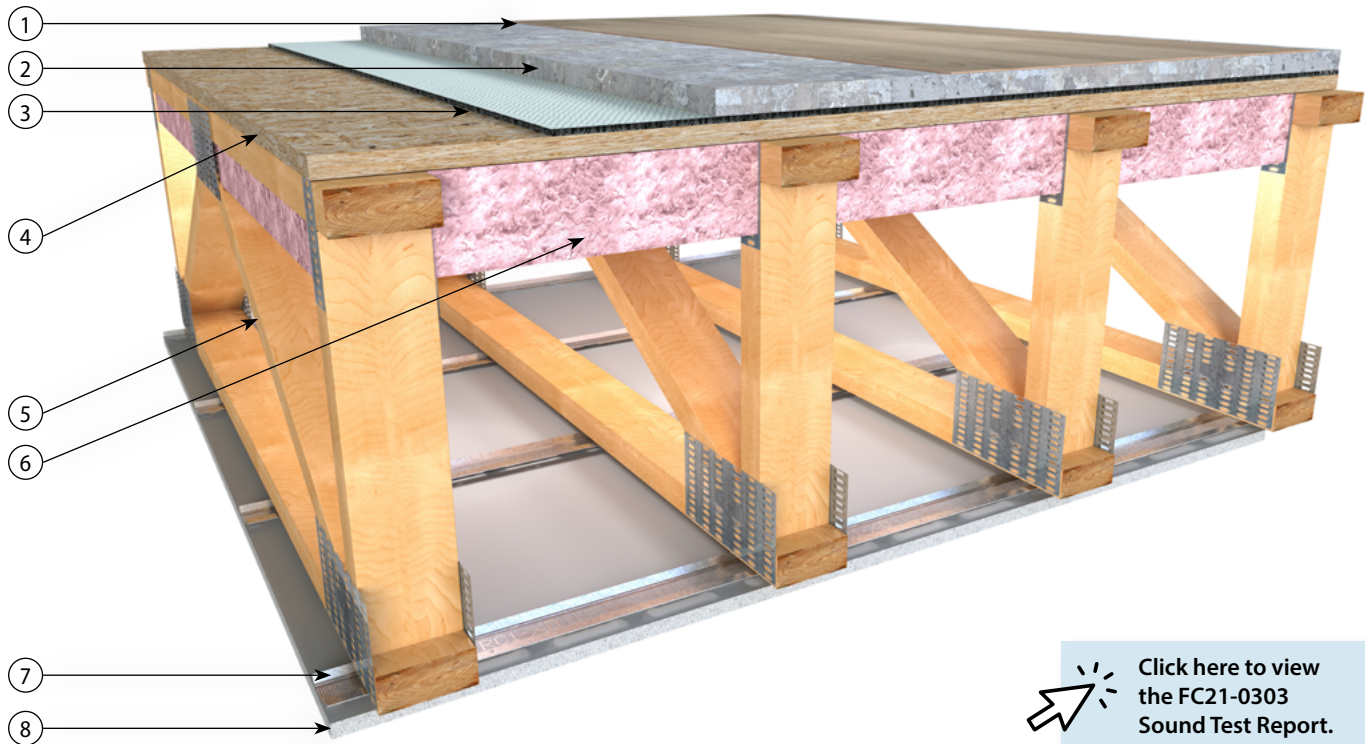
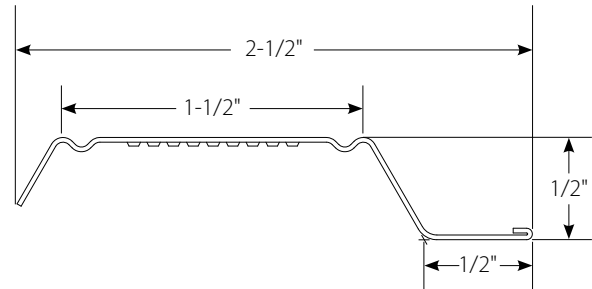

Click here to view
the FC21-0303
Sound Test Report.

RC1-XD Floor/Ceiling Sound Assemblies – FC21-0303

Item	Assembly Description	FC21-0303	IIC	HIIC	STC
1	Finish Floor	Shaw Expo Luxury Vinyl Tile (2 mm)	51	55	60
--	Noise Suppression/Underlayment	n/a			
2	Gypsum Topping	1" USG LEVELROCK Brand 2500 Floor Underlayment (25.4 mm)			
3	Sound Mat	1/4" USG LEVELROCK Brand SAM-N25 Sound Attenuation Mat (6 mm)			
4	Structural Sheathing	3/4" Plywood (19 mm)			
5	Structural Type	18" York PB Truss L/360 OWT (457 mm)			
6	Insulation	Johns Manville R-13 Fiberglass Insulation (89 mm)			
7	Resilient Attachment	1/2" CEMCO RC1-XD™ (13 mm)			
8	Finish Ceiling Layer 1	5/8" USG SHEETROCK Brand FIRECODE C Core Gypsum Panel (16 mm)			

Notes:

1. RC1-XD must be installed per the respective sound test report.
2. All sound test reports performed in accordance with ASTM E90 are available at www.cemcosteel.com.
3. Contact CEMCO Technical Services at 800-416-1178 for additional assistance.
4. Sound Transmission Class (STC) determined in accordance with ASTM E413-10.

RC1-

CEMCO's RC1-XD (Xtra-Duty) Resilient Channel is manufactured from 22 mil thick G40 steel with a large 1-1/2" top screw flange, 1/2" bottom flange for nailing/screwing into wood/steel studs providing a full 1/2" furring height. G60 available upon special request.

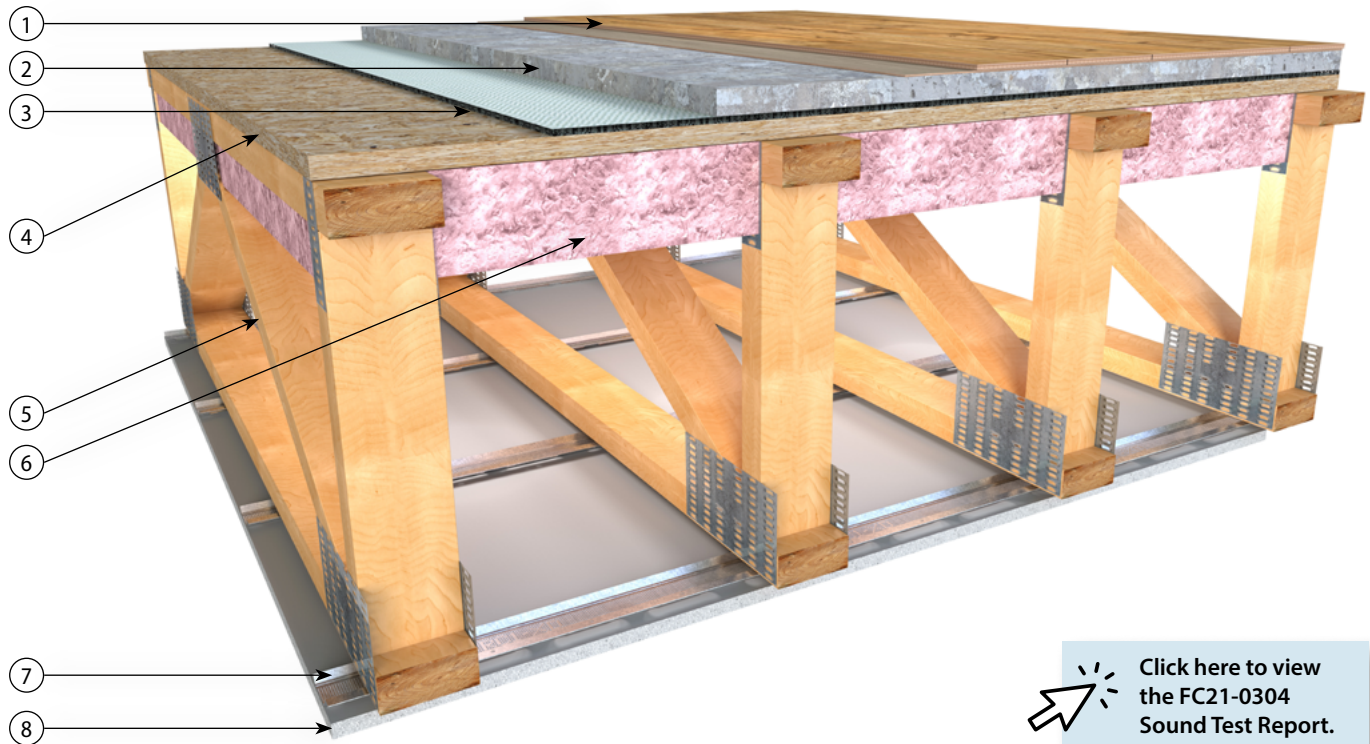
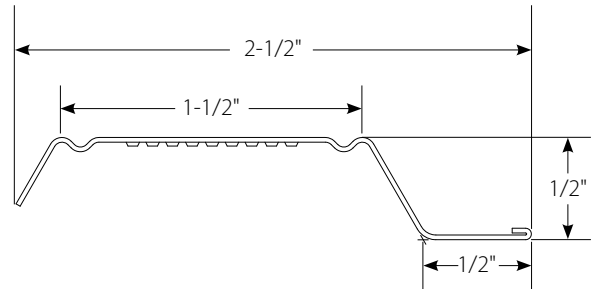

[Click here to view the FC21-0304 Sound Test Report.](#)

RC1-XD Floor/Ceiling Sound Assemblies – FC21-0304

Item	Assembly Description	FC21-0304	IIC	HIIC	STC
1	Finish Floor	Shaw Como Plus Luxury Vinyl Plank (6.5 mm)	52	68	60
--	Noise Suppression/Underlayment	n/a			
2	Gypsum Topping	1" USG LEVELROCK Brand 2500 Floor Underlayment (25.4 mm)			
3	Sound Mat	1/4" USG LEVELROCK Brand SAM-N25 Sound Attenuation Mat (6 mm)			
4	Structural Sheathing	3/4" Plywood (19 mm)			
5	Structural Type	18" York PB Truss L/360 OWT (457 mm)			
6	Insulation	Johns Manville R-13 Fiberglass Insulation (89 mm)			
7	Resilient Attachment	1/2" CEMCO RC1-XD™ (13 mm)			
8	Finish Ceiling Layer 1	5/8" USG SHEETROCK Brand FIRECODE C Core Gypsum Panel (16 mm)			

Notes:

1. RC1-XD must be installed per the respective sound test report.
2. All sound test reports performed in accordance with ASTM E90 are available at www.cemcosteel.com.
3. Contact CEMCO Technical Services at 800-416-1178 for additional assistance.
4. Sound Transmission Class (STC) determined in accordance with ASTM E413-10.

RC1-XDTM

XTRA-DUTY

CEMCO's RC1-XD (Xtra-Duty) Resilient Channel is manufactured from 22 mil thick G40 steel with a large 1-1/2" top screw flange, 1/2" bottom flange for nailing/screwing into wood/steel studs providing a full 1/2" furring height. G60 available upon special request.

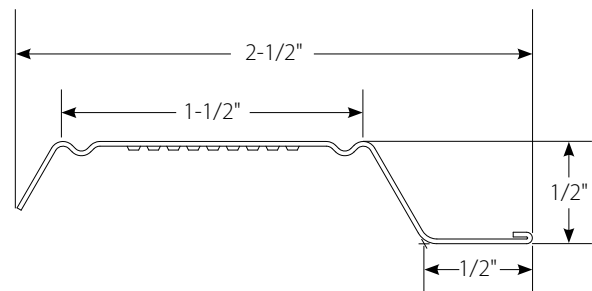

Click here to view
the FC21-0305
Sound Test Report.

RC1-XD Floor/Ceiling Sound Assemblies – FC21-0305

Item	Assembly Description	FC21-0305	IIC	HIIC	STC
1	Finish Floor	Shaw Engineered Wood Flooring (8.4 mm)	52	64	60
--	Noise Suppression/Underlayment	n/a			
2	Gypsum Topping	1" USG LEVELROCK Brand 2500 Floor Underlayment (25.4 mm)			
3	Sound Mat	1/4" USG LEVELROCK Brand SAM-N25 Sound Attenuation Mat (6 mm)			
4	Structural Sheathing	3/4" Plywood (19 mm)			
5	Structural Type	18" York PB Truss L/360 OWT (457 mm)			
6	Insulation	Johns Manville R-13 Fiberglass Insulation (89 mm)			
7	Resilient Attachment	1/2" CEMCO RC1-XD TM (13 mm)			
8	Finish Ceiling Layer 1	5/8" USG SHEETROCK Brand FIRECODE C Core Gypsum Panel (16 mm)			

Notes:

1. RC1-XD must be installed per the respective sound test report.
2. All sound test reports performed in accordance with ASTM E90 are available at www.cemcosteel.com.
3. Contact CEMCO Technical Services at 800-416-1178 for additional assistance.
4. Sound Transmission Class (STC) determined in accordance with ASTM E413-10.

RC1-

CEMCO's RC1-XD (Xtra-Duty) Resilient Channel is manufactured from 22 mil thick G40 steel with a large 1-1/2" top screw flange, 1/2" bottom flange for nailing/screwing into wood/steel studs providing a full 1/2" furring height. G60 available upon special request.

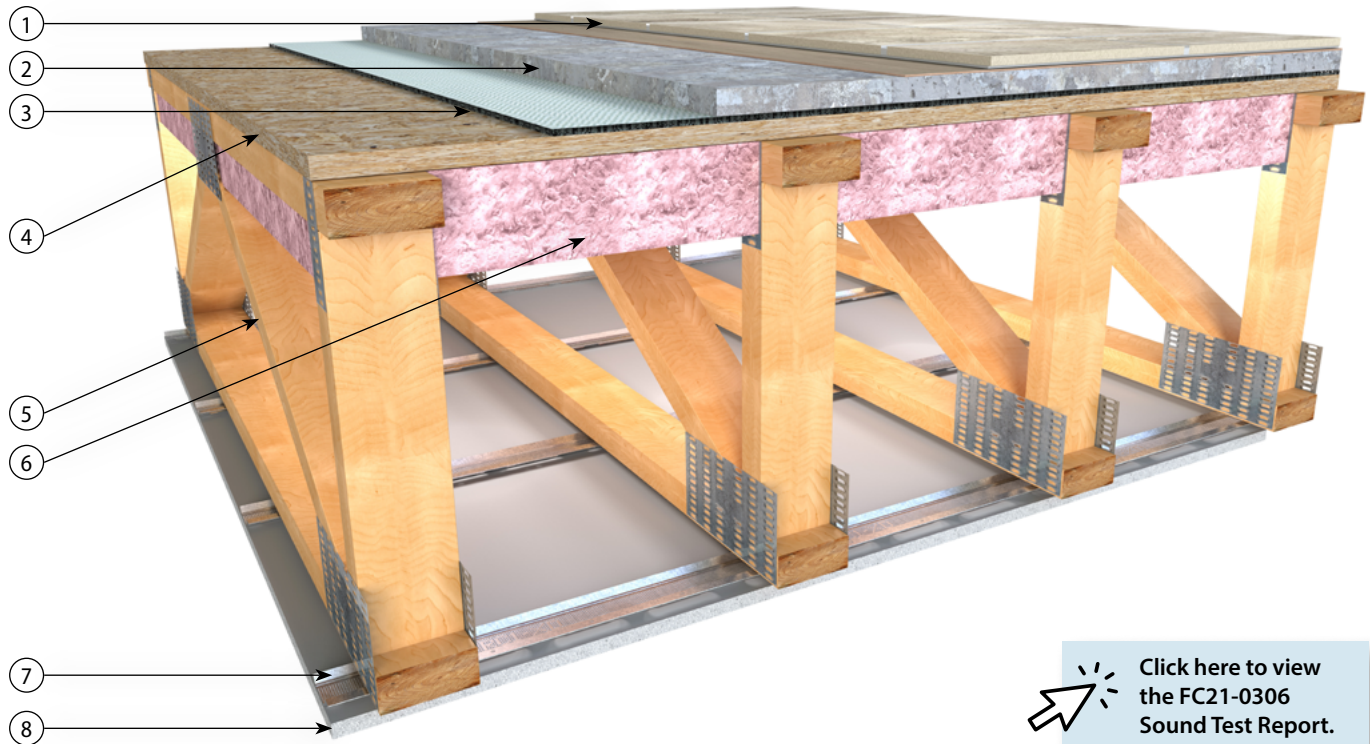
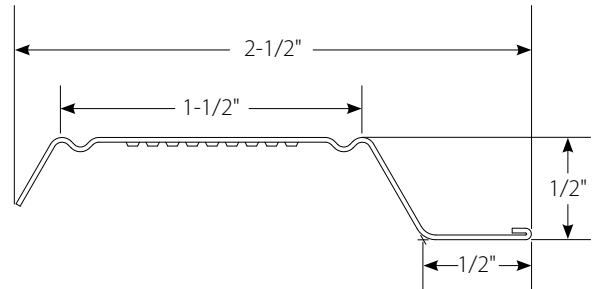

[Click here to view the FC21-0306 Sound Test Report.](#)

RC1-XD Floor/Ceiling Sound Assemblies – FC21-0306

Item	Assembly Description	FC21-0306	IIC	HIIC	STC
1	Finish Floor	Daltile Ceramic Tile (10.5 mm)	54	55	61
--	Noise Suppression/Underlayment	n/a			
2	Gypsum Topping	1" USG LEVELROCK Brand 2500 Floor Underlayment (25.4 mm)			
3	Sound Mat	1/4" USG LEVELROCK Brand SAM-N25 Sound Attenuation Mat (6 mm)			
4	Structural Sheathing	3/4" Plywood (19 mm)			
5	Structural Type	18" York PB Truss L/360 OWT (457 mm)			
6	Insulation	Johns Manville R-13 Fiberglass Insulation (89 mm)			
7	Resilient Attachment	1/2" CEMCO RC1-XD™ (13 mm)			
8	Finish Ceiling Layer 1	5/8" USG SHEETROCK Brand FIRECODE C Core Gypsum Panel (16 mm)			

Notes:

1. RC1-XD must be installed per the respective sound test report.
2. All sound test reports performed in accordance with ASTM E90 are available at www.cemcosteel.com.
3. Contact CEMCO Technical Services at 800-416-1178 for additional assistance.
4. Sound Transmission Class (STC) determined in accordance with ASTM E413-10.



Expanding Your Solutions

Corporate Headquarters

13191 Crossroads Parkway North, Suite 325, City of Industry, CA 91746

P: 800.775.2362 | **F:** 626.330.7598

Southern California Manufacturing Facility

263 North Covina Lane, City of Industry, CA 91746

P: 800.775.2362 | **F:** 626.330.7598

Northern California Manufacturing Facility

1001-A Pittsburg Antioch Hwy, Pittsburg, CA 94565

P: 925.473.9340 | **F:** 925.473.9341

Denver Colorado Manufacturing Facility

490 Osage Street, Denver, CO 80204

P: 303.572.3626 | **F:** 303.572.3627

Fort Worth Texas Manufacturing Facility

8600 Will Rogers Blvd, Fort Worth, TX 76140

P: 817.568.1525 | **F:** 817.568.2759

www.cemcosteel.com

